

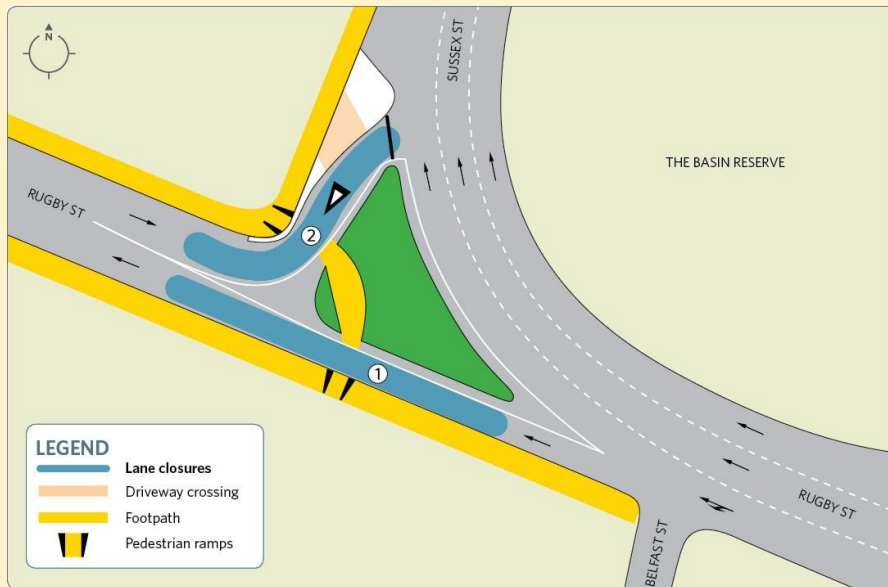

# National War Memorial Park and Underpass

## Sunday night road sealing on Rugby Street



**Sunday 29 September 3.00pm – 11.00pm depending on conditions**

Lane closures will be at separate times in the following sequence:

- Milling of (1) the entrance into upper Rugby Street, followed by the exit (2) – this is the noisiest work and should be completed by early evening
- Tarsealing of the entrance (1), followed by the exit (2).

### Dear Neighbours,

We need to close parts of upper Rugby Street at intervals this Sunday to reseal the road surface at the intersection with Sussex Street.

The resealing follows the safety work undertaken in recent weeks and will require us to work late into the evening. The lanes at the intersection will be closed at separate times.

Our traffic supervisors will help nearby residents with access to and from their homes. We ask other motorists to please use other routes to Tasman Street which will be open from John Street on Sunday.

Thank you for your patience.



*Directional drill*

### Hole-boring machine drills 9m deep under road

A bright blue machine passersby may have noticed on site is the directional drill that is installing a stormwater pipe from the trench to Cambridge Terrace.

The pipe will run 9 metres below Sussex Street and will take water from the underpass a distance of 200 metres to the recently installed stormwater filter at Cambridge Terrace. Wires were laid across the road and footpath for several days to provide a magnetic guidance system to ensure the drill made the hole in the right place.

Installation is a three-stage process. The drill initially screwed interlocking rods through the ground to make a narrow pilot hole. It will now reel a reaming tool back through the hole which will rotate and cut the hole large enough for the stormwater pipe. While the drill works, it pumps a slurry of expanding bentonite clay into the hole to stop it from caving in.

The final stage is to pull 200 metres of polyethylene stormwater pipe, which is 710mm in diameter, through the hole. We are welding several pipes together to make two 100-metre lengths. The final weld will be made as the pipe goes through the hole.



*Interlocking rods being screwed through from the trench to Cambridge Tce for the pilot hole*

## Contact us

# What's happening around the project site

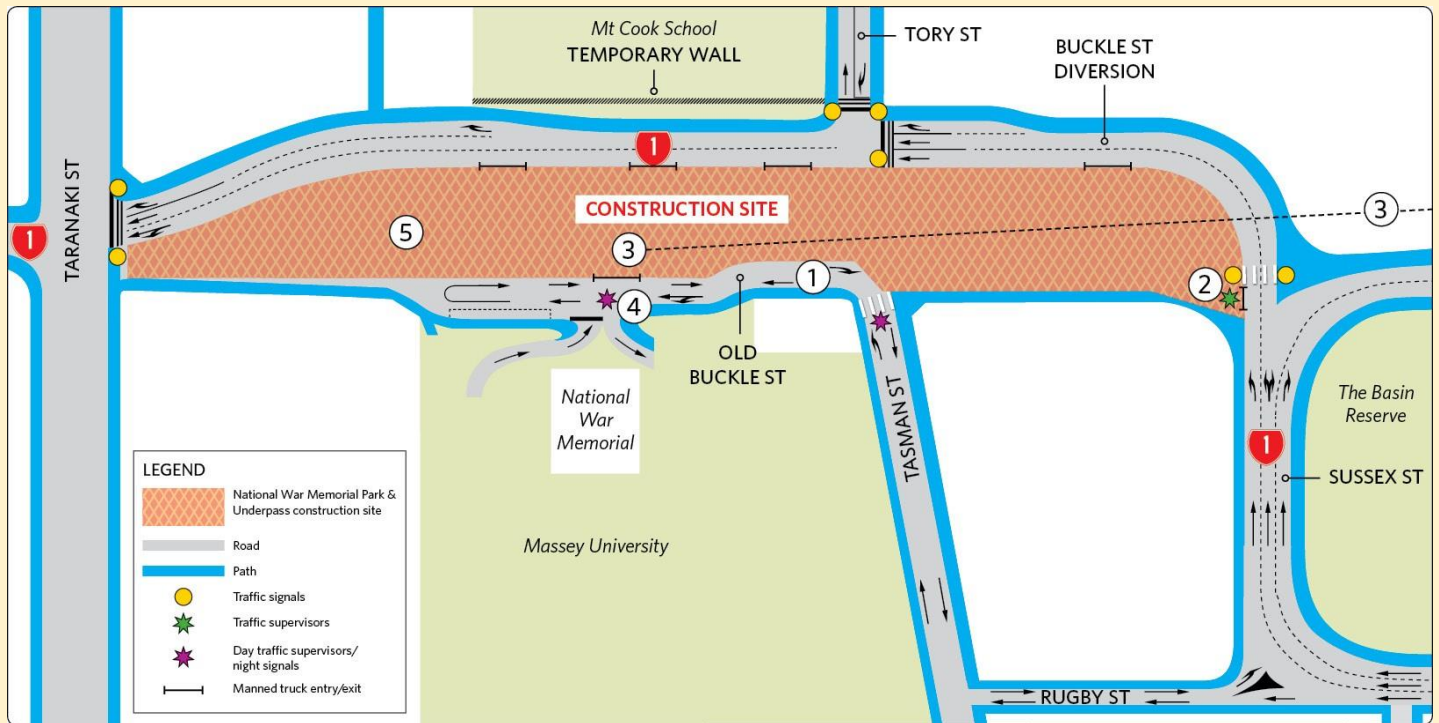

## Underground services

- ① **From Taranaki Street end:**  
New water main being installed outside the underpass trench from Taranaki Street to Tasman Street
  - Earthworks on the project site near Mount Cook Police Barracks
- ② **From Sussex Street end:**  
Stormwater pipe works beside the Basin Reserve Apartments – completed
  - The grass verge beside the apartments will be restored with topsoil and grass seed in the near future
- ③ **Trench to Cambridge Terrace**  
Dotted line marks the 200-metre path of the stormwater pipeline from the bottom of the underpass trench to the stormwater filter chamber beside the footpath on Cambridge Terrace
- ④ **Old Buckle Street to National War Memorial**  
Sewer installation
  - From next week, minor changes to pedestrian and vehicle routes at the start of the Massey University access road
  - Route marked with cones and supervised by a traffic warden

## Ongoing work

- ⑤ **Taranaki Street end (west)**  
Installing piles for the underpass – 95 piles to be installed, 10m – 30m deep depending on depth of soil over bedrock
    - Concrete trucks at the Taranaki Street end of the site most days
    - Exit and entry points manned by traffic wardens
- All of site**  
Continuing trench excavation – 95% complete  
Installing ground anchors for retaining walls – 12 left to install of a total 558
- Anchor crew works 6.00am – 8.00pm
  - Generator lighting turned off when they finish
- General site work hours**  
Mon – Fri: 6.00am–6.00pm  
Noisy work after 7.00am  
Sat: 7.00am – 2.00pm  
Noisy work after 8.00am
- We try to give our neighbours a timely warning of activities they may find disruptive. However, some activities may occur at short notice as the work programme is adapted to optimise progress.

## Contact us